

Pretest DD
MTH-P023
Information

The use of a calculator is allowed

Conversions:

1h=60 min
1min=60 sec

1 in=2.54 cm
1km=1000m
1m=100 cm
1lb= 0.45 kg

Scale: $\frac{\text{Diagram}}{\text{real}} = \frac{D}{R}$

Formulas: $s = \frac{d}{t}$ $t = \frac{d}{s}$ $d = s \times t$

s= speed t= time d= distance

Taxes: **GST = 5%**

QST= 9.975%

(3 points)

1. Write the following numbers in English:

- 311: -----
- 87: -----
- 452: -----

(3 points)

1. Please fill in this cheque using the following information:

- Date: 14-September-2022
- Pay to Canadian Express
- Amount to pay: \$ 140.64

2815

Date _____

Pay to the Order of _____ \$ _____

_____ Dollars

Memo: _____

⑆ 8587 67 13 ⑆ 1863588757 1⑆ 1163 8

(7 points)

2. Compare the following numbers using symbols : $<$, $=$, $>$.

- -1.8 -0.3
- 3.8 2.76
- 0.018 0.081
- -0.56 -0.57
- -4 3
- 2.4 2.4
- -42 -34

(5 points)

3. Round the following numbers:

- a. 17822 to the nearest thousand = -----
- b. 545.23 to the nearest ten = -----
- c. 9.15476 the nearest hundredth = -----
- d. 22.667 to the nearest unit = -----
- e. 47.3501 to the nearest tenth = -----

(8 points)

4. **Solve the following proportions:** (When necessary, round the answer to the nearest tenth)

$$\frac{3}{5} = \frac{x}{90}$$

Answer: $x =$

$$\frac{6}{x} = \frac{3}{10}$$

Answer: $x =$

$$\frac{x}{20} = \frac{5}{4}$$

Answer: $x =$

$$\frac{4}{15} = \frac{8}{x}$$

Answer: $x =$

(6 points)

5. **Find the following percentages:**

▪ **18% of 250 =**

▪ **10% of 70 =**

(8 points)

6. Convert the following measurements using the information sheet at the beginning of the test:

a) Convert 45 inches into cm: ----- cm

b) Convert 34 lbs into kilos: -----kg

c) Convert 9 kg into pounds: -----lbs

d) Convert 4 m into inches: -----inches

\$CAN 1 = € 0.7115 (Euros)

(5 points)

7. Georgia is in Marrakech. She bought a very expensive carpet at € 175.50 (Euros).

How much does this carpet cost in Canadian dollars?

(10 points)

8. Anne-Marie works at the sports store. She has worked 22 hours this week. Her hourly salary is \$18.25.

What is her **Gross Salary**?

Her salary deductions form 16.5% of her Gross Salary. What is her **NET Salary**?

(15 points)

9. Marc has bought a new house and wants to know the real dimensions of his Living Room. Can you help him find first the scale and then the real measurements of the Living Room?

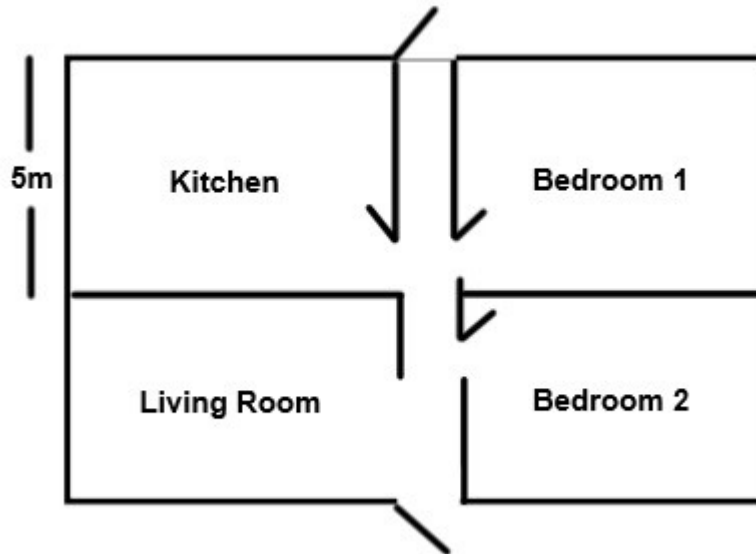

1. Find the scale.

2. Find the real measurements of the Living Room.

(10 points)

10.

You share a duplex with 4 more people. These are the monthly expenses:

Hydro.....	\$ 175.00
Rent.....	\$1,425.00
Groceries.....	\$ 400.00
Insurance.....	\$ 60.00
Phone.....	\$ 55.00
Cable.....	\$ 104.00
Miscellaneous.....	\$ 190.00

a) Calculate the total expenses

b) How much does each roommate have to pay per month?

(10 points)

11.

- a. Veronica is travelling from Montreal to Riviere du Loup by car. If the distance between Montreal and Riviere du Loup is 431.4 km and she travels at 115 km/h, how much time will she need to arrive at Riviere du Loup?

(Do not forget to use the formula in the information sheet)

- b. If Veronica decides to go from Riviere du loup to Matane and she travels at 90 km/h, how much time will it take her to arrive at Matane? (knowing that the distance between Riviere du Loup and Matane is 200.8 Km.)

